

Lens Module: AES-014160-GAB001

Absolute maximum ratings

| Item | Rating |
|---------------------|---------------------|
| Maximum input power | 1 W/cm ² |

Optical characteristics (T housing=25°C)

| Item | spec | Remarks |
|----------------------------|---------------|------------------------------|
| Operating wavelength range | 360 ~ 1300 nm | transmitting range of glass |
| | 450 ~ 700 nm | coating range T < 2%@surface |
| Efficiency | > 98.0 % | except surface reflection |
| Flatness (CV) | < 5 %rms | CV=σ / x (ave.) |
| Fake spot intensity | 0.0 % | no fake spots |

Input Collimated Gaussian profile CSDOE Square Module External converging lens with focal length = f mm Output profile on the focal plane

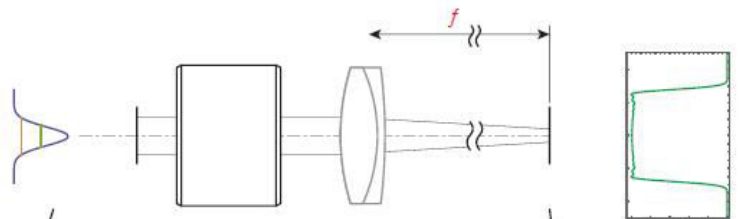

Dimension

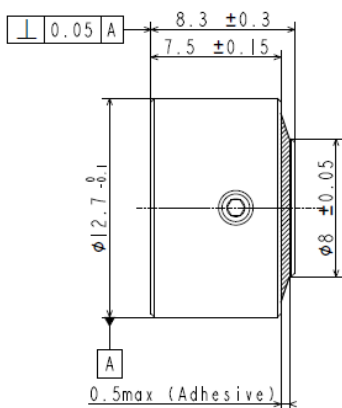

1/e² width = 1.6mm
FWHM 0.94mm

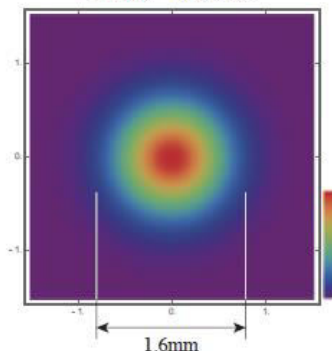

FWHM width $\approx 0.0061 f$ mm
note: FWHM is independent from λ

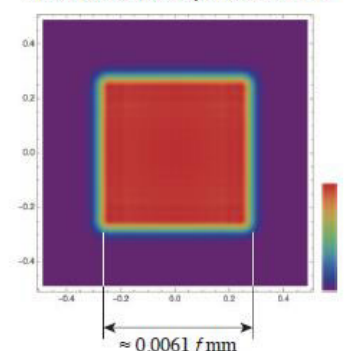

Application examples : Laser ablation

| Item | spec | Remarks |
|---------------------------------|-------------------|---------|
| Focal length of converging lens | 100 mm | |
| Length of one side | 600 μm | FWHM |
| Aspect ratio | 1.0 | |

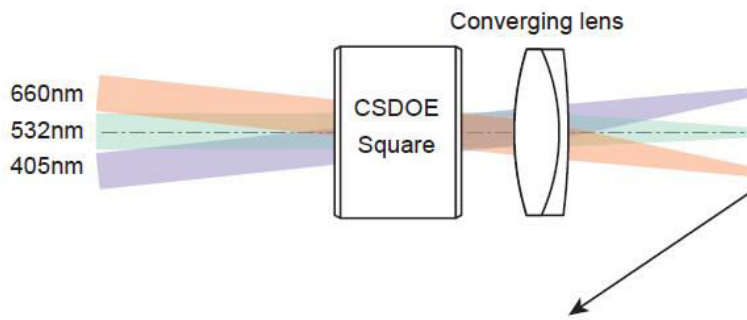

Relative intensity profiles for typical wavelength, in the case of $f = 100\text{mm}$

